

Contact information:

TERUMO UK Ltd.

Tamesis, The Causeway, Egham
Surrey, TW20 9AW
United Kingdom

Free phone number: 0800 988 4617
email: diabetes@terumo-europe.com
website: www.terumo-diabetes.com

Name:
Address:
Tel:







In case of emergency, please contact:

Name:
Address:
Tel:







Treating doctor:
Hospital – department:
Tel:

LC-7321en, August 2010

Error indications on the display.
(See Guide Book p. 37-41 for more information)

Indication	Cause
	Test TIP is inserted at an angle (not straight), or Test TIP is not fully inserted. Used Test TIP is attached on the Meter. Measuring window is dirty or dusty. Please also refer to p. 50-53 "Meter operation check"
	Measuring window may be dirty or dusty. Clean the measuring window with a cotton swab. Please also refer to p. 50-53 "Meter operation check"
	Environmental temperature is out of specification (10-35°C).
	The measuring environment is too bright. Point the meter at a darker place or move to a place not exposed to direct sunlight. "L" indication will disappear.
	Blood glucose value is higher than 33.3 mmol/L.
	Blood glucose value is lower than 1.1 mmol/L.

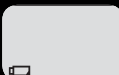
Error indications on the display.
(See Guide Book p. 37-41 for more information)

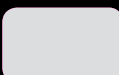
Indication	Cause
	Test TIP came off during measurement.
	The measuring environment is too bright. Test TIP came off during measurement.
	The Meter is out of order. Contact Terumo.
	Indication blinks The batteries are almost empty.
	Batteries are empty. Measurement cannot be executed.
	Indication disappears 2 minutes passed without any action (In case the Test TIP is not on the Meter.) 5 minutes passed without any action (In case the Test TIP is on the Meter.)
	No indication on the display The "⓪" button was not pressed. The battery is placed incorrectly. The batteries are empty.

mmol/L

TERUMO FINETOUCH®

Blood Glucose Monitoring System for Self-Testing

SHORT INSTRUCTIONS FOR USE

 Carefully read detailed instructions in the guide book before using the blood glucose meter for the first time.

STEP 1 – PREPARATION

Wash and dry your hands thoroughly prior to use

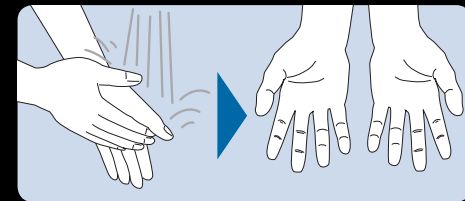

STEP 2 – ATTACH TEST TIP

Remove the protective cap

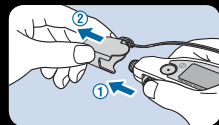

1. Move the eject button forward.
2. Pull off the protective cap.

Press the “ⓘ” button



You will hear the Meter Beep.

Insert the Test TIP (with blue film-seal)



Remove the film-seal from the TIP case.

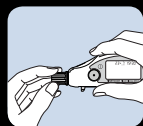

Put the TIP with the case onto the Meter.

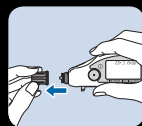

Remove the TIP case.



After two beeps, “OK” will appear on the display.

STEP 3 – BLOOD SAMPLING

Turn the dial to select the desired lancing depth

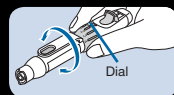

Insert the lancet

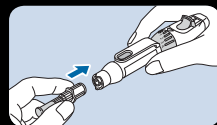

Insert the lancet until you hear a clear “Click”.

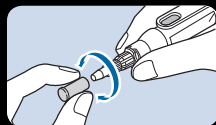

Twist and pull the cap to remove it from the lancet.

Prick your finger

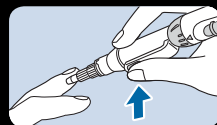

Place the lancet gently against the skin and press the Push button.

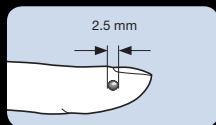

Gently squeeze around the puncture site until you have a droplet of blood of about 2.5mm.

STEP 4 – MEASURING

Make sure the display shows “OK”



If the display is empty, press the “ⓘ” button and wait until “OK” appears on the display.

Apply the Test TIP to the blood sample

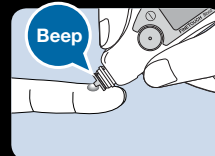

Do not push the Test TIP against the skin. Remove the Test TIP from the droplet of blood as soon as you hear a beep.

Read the results from the display



A countdown from 10 to 1 seconds shows the remaining measuring time. After the “beep” the result will be shown on the display.

STEP 5 – CLEAN UP

Remove the Test TIP and turn off the Meter

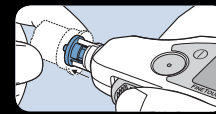
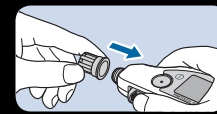

Cover the Test TIP with the TIP case. Slide the eject button forward to remove the Test TIP. Remove the case with the TIP from the Meter.

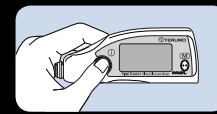

Press the “ⓘ” button for more than 1 second to turn off the Meter.

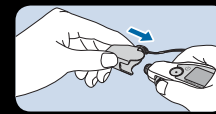

Place the protective cap back on the Meter tip.

Remove the lancet

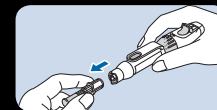

Remove the lancet from the lancing device and dispose of it safely into a Sharps container.

Attention: Once the lancet is removed from the lancing device, do not reinsert it. If you do, the needle will be exposed and you may be at risk of accidental needle stick.